

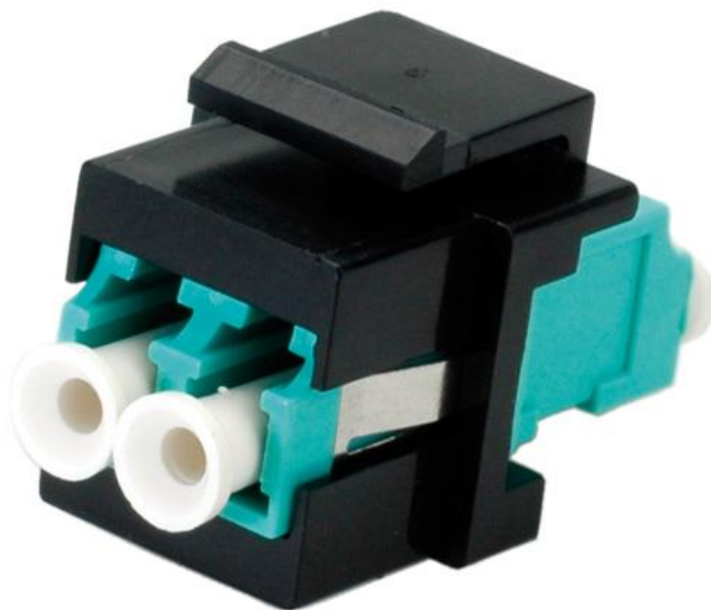

Datenblatt - Fiche technique - Data sheet

21.17.0001



ROLINE Keystone LWL-Adapter LC/LC Duplex, Multimode, OM3

ROLINE Raccord optique LC/LC duplex multimode, Keystone, OM3

ROLINE Fiber Optic Keystone Jack, LC Duplex, Multimode, OM3

Item no.: 21.17.0001

ROLINE Fiber Optical Keystone Jack, LC Duplex, Multimode

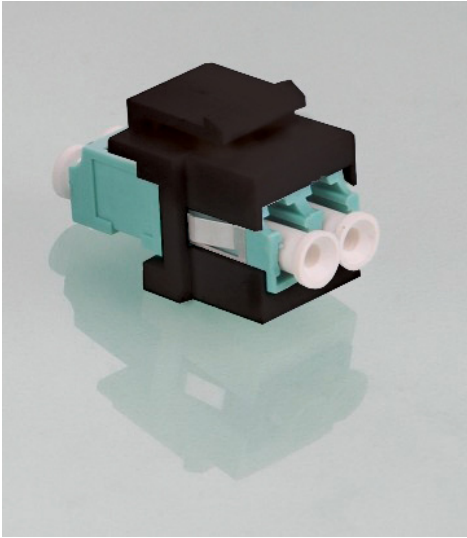

Features:

- Keystone type adapter, LC sleeve, Duplex, multi-mode
- Material: ABS (keystone adapter) in black color
- Material: Ceramic (LC sleeve) in Aqua color

Page 1 of 2

keystone type LC Adapter

NOTE:
RoHS & Reach COMPLIANT

| | |
|----------------------------|----------|
| Insertion Loss (dB) | ≤0.30 |
| Operating Temperature(° C) | -40 ~+85 |
| Storage Temperature(° C) | -40 ~+85 |

Dimensions:
 LC Sleeve ceramic: 14.9±0.5, 6.2, 9.4±0.2
 LC Aqua Body: 1.8^{+0.2}/_{-0.1}, 2.8±0.3, 29.2±0.4, 3

MATERIAL LIST:

| | | | |
|-----|-------------------------------------|-------------------|--------|
| ⑥ | LC Aqua Body (SC simplex footprint) | 1pcs | |
| ⑤ | LC Sleeve ceramic(Multi-Mode) | 1pcs | |
| ④ | Aqua bush | 2pcs | |
| ③ | LC Aqua Body (SC simplex footprint) | 1pcs | |
| ② | LC Metal Mount | 1pcs | |
| ① | LC White Dust Cap | 4pcs | |
| NO. | SPECIFICATION STANDARD | QT ³ Y | REMARK |

| | | | |
|---|--|------------|--|
| Rotronic Co., Ltd | | | |
| ROLINE F.O. Keyst. Jack, LC Duplex, Multimode | | | |
| ITEM NO. | | 21.17.0001 | |

| | | | | | | | |
|-----|-----|-------------------------------|------|---------|------------|--------|------------|
| NEW | | 2012-02-09 | A | DRAWNBY | CHECKBY | APPOBY | DATE |
| BY | CHK | REVISION RECORD MODIFICATIONS | DATE | REV. | LV WENFENG | ALVAN | 2012-02-09 |

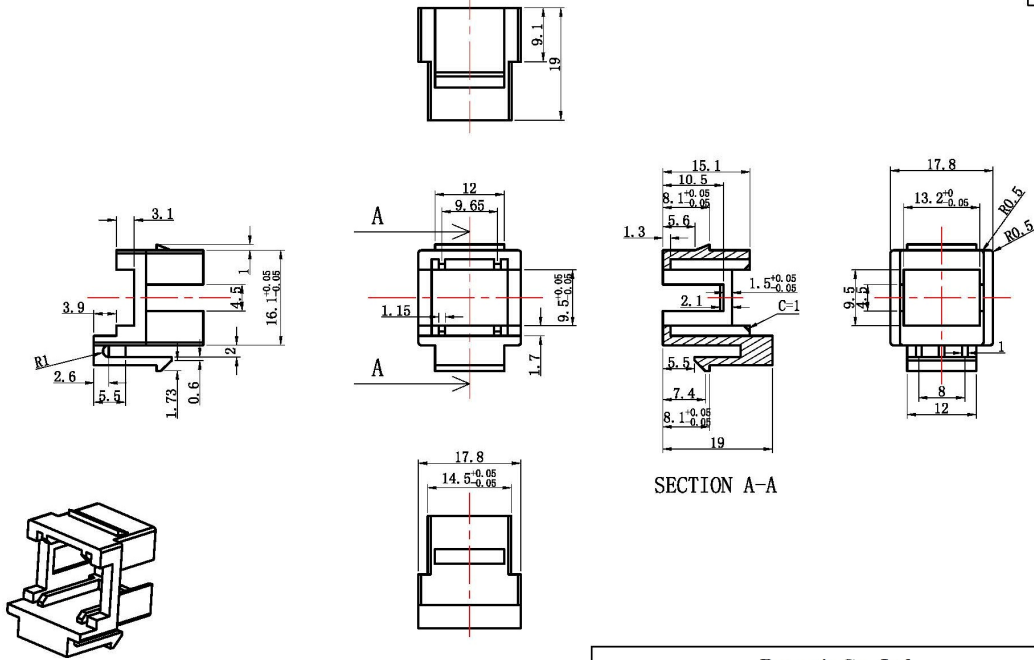

ABS, Black
ROHS compliant

| | | | | | | | | |
|--|-----|-------------------------------|------------|------|---------|----------|------------|------------|
| Rotronic Co., Ltd. | | | | | | | | |
| ROLINE F.O. Keyst. Jack, LC Duplex, Multimode | | | | | | | | |
| | | | | | | ITEM NO. | 21.17.0001 | |
| | | NEW | 2012-02-09 | A | DRAWNBY | CHECKBY | APPOBY | DATE |
| BY | CHK | REVISION RECORD MODIFICATIONS | DATE | REV. | Elaine | Alvan | | 2012-02-09 |